

DETAIL ①
ANGLE BOLTED TO TIE STRIP

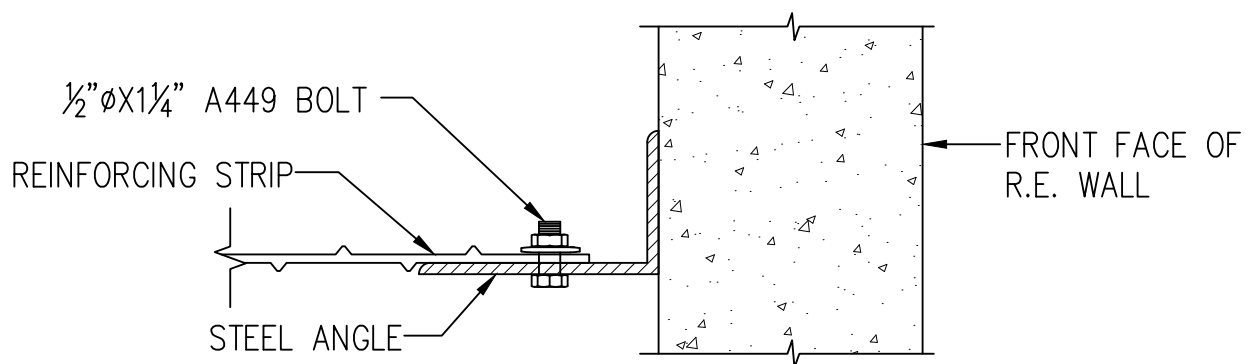

DETAIL ②
SHIFTED REINFORCING STRIP BOLTED TO ANGLE

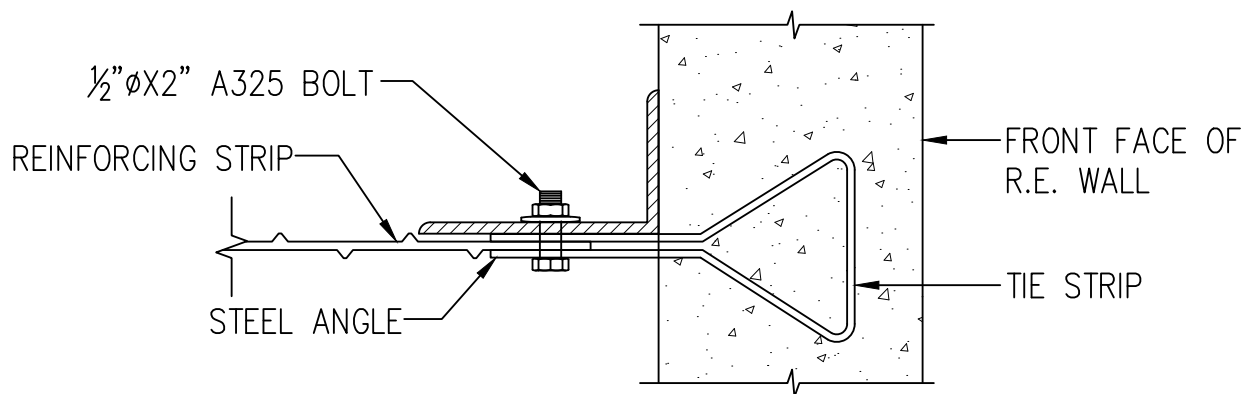

DETAIL ③
REINFORCING STRIP AND ANGLE BOLTED TO TIE STRIP

IMPORTANT NOTE ABOUT DIMENSIONS

Dimensions used in this document are for illustrative purposes only and may vary slightly from precise design or fabrication dimensions due to English/Metric conversion or due to simplification appropriate to the guideline character of this manual. When required for design, precise dimensions (each project uses either English or Metric) should be obtained from contract plans or directly from Geoquest USA. Geoquest USA reserves the right to change the dimensions of fabricated materials as needed.



REINFORCING STRIP
CONNECTION DETAILS AT
VERTICAL INCLUSIONS

FIGURE NO.
ANGLE.CONN
DATE
05/27/2025